

EDGE-mini

INTILED



Smaller and simpler

Ultrasmall luminaire for monochrome lighting of window openings

One tiny lighting device that will provide even lighting of the entire width of the window opening with a beam of 8x180 degrees. The adjustment mechanism will allow the most flexible adjustment of the lighting to the specifics of a particular placement



# EDGE-mini LIGHTING EFFECT

I N T I L E D

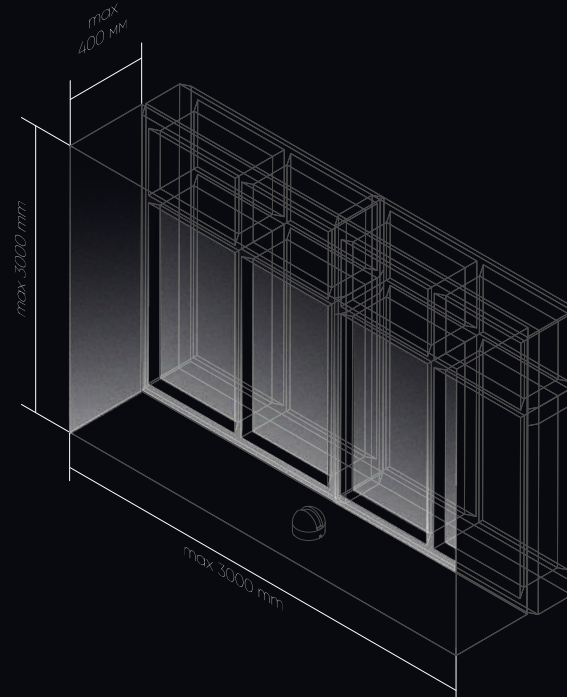
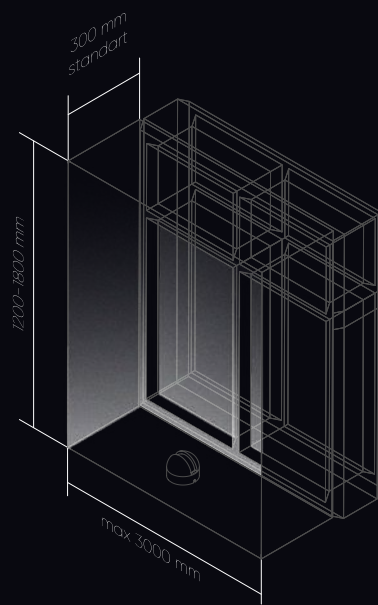
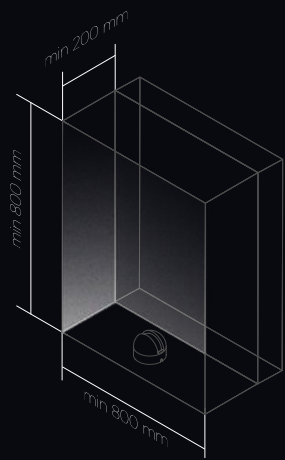

**EDGE-mini LIGHTING EFFECT**

**I N T I L E D**



## EDGE-mini SPECIFIC FEATURES

I N T I L E D

A wide beam providing uniform illumination of even deep window openings

Highest quality of light by latest generation LEDs with high-precision calibration

Flexibility of adjustment on site due to built-in adjustment mechanism



## EDGE-mini MAIN TECHNICAL CHARACTERISTICS

I N T I L E D

Light source	Nichia (Japan), Cree (USA) LEDs
Light color	white (3000 K, 4000 K, 5000 K), amber, blue, green, red
Optics	8x180°
Luminous flux	30 - 110 lm
Wattage	4,5 W
Voltage	12 V DC
Protection class	IP65
Operating temperature	tropical edition: -40°C ... +55°C standard edition: -40°C ... +45°C
Lifespan	not less than 50 000 hours
Control	PWM
Dimensions	62x62x51 mm
Weight	0,3 kg
Mounting	surface mounting on mounting plate; mounting on adjustable bracket
Customization	housing and accessories painting in any RAL color, IP68 connectors; accessories

**EDGE-mini DIMENSIONAL DRAWING**

I N T I L E D

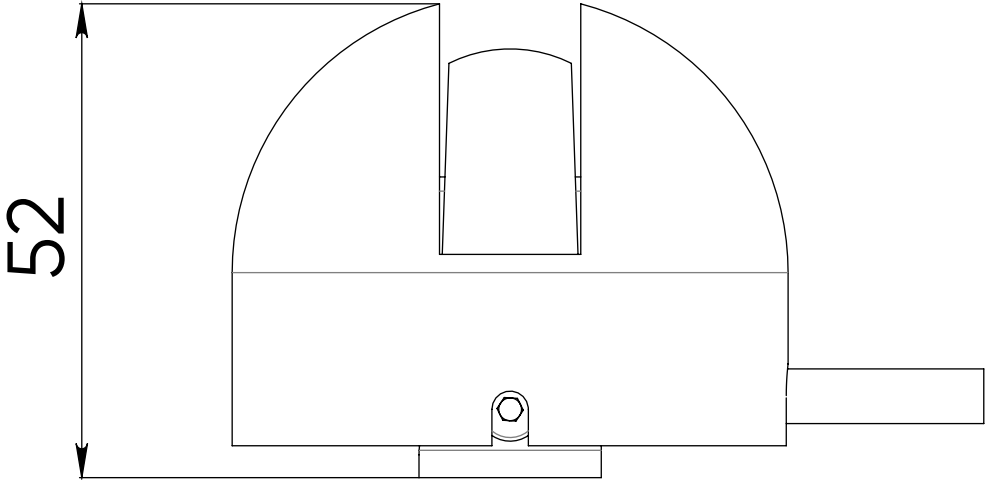
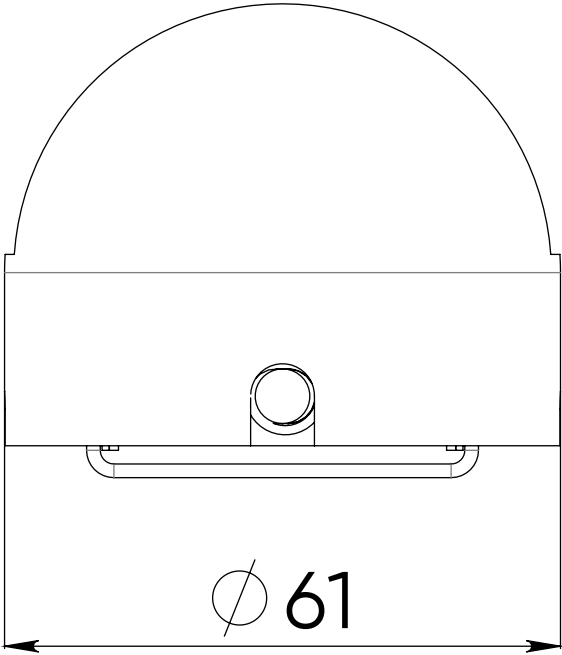

# EDGE-mini CONNECTIONS DIAGRAM

I N T I L E D

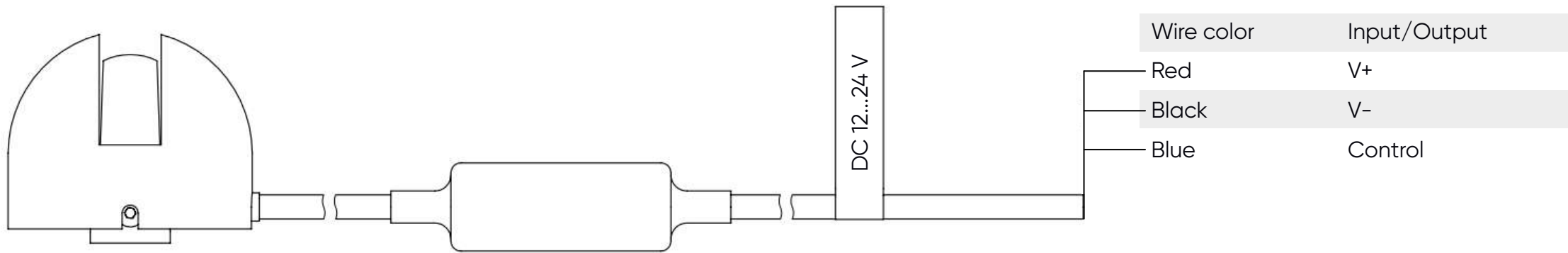



# PORTFOLIO

INTILED

General Tutolmin's house  
Saint-Petersburg



# PORTFOLIO

Titul  
Moscow



INTILED





more information available  
on the website